

Type without bore
(from size F 430 roughbored)

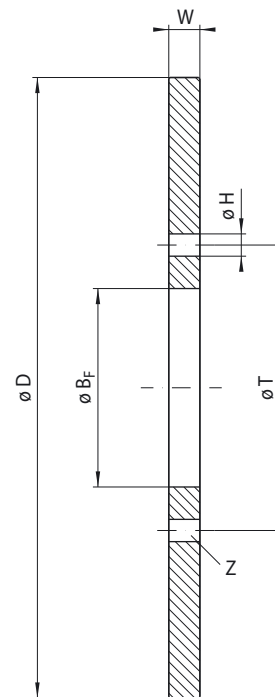

Type with centre bore

64-1

Size	D mm	W mm	Type without bore/roughbored		Type with centre bore					Permissible speed min ⁻¹	Inertia moment kgm ²
			Article number	Bore B_v mm	Article number	Bore B_f^{H7} mm	H mm	T mm	Z		
F 125/12,5	125	12,5	2471.125.150	-	2471.125.152	40	9	56	4	14500	0,0022
F 150/12,5	150	12,5	2471.150.150	-	2471.150.152	50	9	66	4	12100	0,0045
F 200/12,5	200	12,5	2471.200.150	-	2471.200.151	63	11	83	8	9100	0,0141
F 250/12,5	250	12,5	2471.250.150	-	2471.250.159	80	11	100	8	7300	0,0345
F 300/12,5	300	12,5	2471.300.150	-	2471.300.155	100	14	122	8	6000	0,072
F 355/12,5	355	12,5	2471.355.150	-	2471.355.152	110	14	132	10	5100	0,140
F 430/12,5	430	12,5	2471.430.150	50	2471.430.157	125	14	147	12	4200	0,302
F 520/12,5	520	12,5	2471.520.150	50	2471.520.158	160	14	182	16	3500	0,646
F 630/25	630	25	2471.630.150	75	-	-	-	-	-	2900	2,78
F 710/25	710	25	2471.710.150	95	-	-	-	-	-	2600	4,49
F 800/25	800	25	2471.800.150	95	-	-	-	-	-	2300	7,24
F 900/25	900	25	2471.900.150	120	-	-	-	-	-	2000	11,59
F 1000/25	1000	25	2471.990.150	120	-	-	-	-	-	1800	17,7

Other sizes of brake discs

For Brake Calipers DV 030 and DH 030, brake discs with diameters ranging from $D = 200$ mm up to 520 mm are also available with a disc thickness of $W = 25$ mm.

Material

The Brake Discs are made from GGG-50 (DIN 1693).

Dimensioning

Please refer to the technical points on pages 72 to 74 when dimensioning the brake disc size.

Any questions? Please contact us.